

外部委託業者の募集

References: IO/26/OT/10034607/ADC

"Supply Contract for Lifting Hoist and Monorail for Handling of Baskets with Specimens of ITER Corrosion Monitoring Chambers "

(ITER 腐食モニタリングチャンバーの試験片バスケット取扱い用揚重ホイストおよびモノレールの供給契約)

IO 締め切り 2026 年 6 月 30 日(火)

○はじめに

本事前情報通知 (PIN) は、作業契約の入札授与および実行につながる公開入札調達プロセスの最初のステップです。

この文書の目的は、作業範囲および入札プロセスに関する技術的内容の基本的な概要を提供することです。

○背景

ITER は平和利用の核融合発電の科学的小および技術的な実現可能性の実証を目的とした、国際共同研究開発プロジェクトです。ITER 機構の 7 つのメンバーは、;欧州連合 (EURATOM が代表)、日本、中華人民共和国、インド、大韓民国、ロシア連邦、および米国です。

ITER の敷地はフランス南東部のブーシュデュロヌ地区にあり、ITER 本社 (HQ) もあるフランス CEA サン・ポール・レ・デュランス に近いところに位置しています。詳細については、ITER のウェブサイト <http://www.iter.org> を参照して下さい。

○作業範囲

供給範囲の詳細については、添付の2026年3月17日付け技術仕様書 (参照 : FRRNC3 v1.1) に記載されています。

○調達プロセスと目的

目的は、競争入札プロセスを通じて供給契約を落札することです。

この入札のために選択された調達手続きは公開入札手続きと呼ばれます。

オープン入札手順は、次の 4 つの主要なステップで構成されています。

➤ ステップ 1-事前情報通知 (PIN)

事前情報通知は公開入札プロセスの第一段階です。IO は、関心のある候補企業に対し、以下の概略日程に示された期日までに担当調達担当官に添付の関心表明フォームで以下の情報を提出し、競争プロセスへの関心を示すよう正式に要請します。

特に注意:

関心のある候補企業は、IO Ariba の電子調達ツール 「IPROC」 に登録してください (ま

だ登録していない場合)。手順については、
<https://www.iter.org/fr/proc/overview>
を参照してください。

Ariba (IPROC) に登録する際には、お取引先様に最低 1 名の担当者の登録をお願いしま
す。この連絡担当者は、提案依頼書の発行通知を受け取り、必要と思われる場合は入札書類
を同僚に転送することができます。

➤ ステップ 2-入札への招待

関心表明提出後、提案依頼書 (RFP) を「IPROC」に掲載します。この段階では、担当の
調達担当者に関心を示し、かつ IPROC に登録している関心のある候補企業は、RFP が公表
された旨の通知を受けることができます。その後、RFP に詳述されている入札説明書に従っ
て提案書を作成し、提出します。

このツールに登録されている企業のみが入札に招待されます。

➤ ステップ 3-入札評価プロセス

入札者の提案は、IO の公平な評価委員会によって評価されます。入札者は、技術的範囲に沿
って、かつ、RFP に記載された特定の基準に従って作業を実施するために、技術的遵守を証
明する詳細を提供しなければなりません。

➤ ステップ 4-落札

認定は、公開されている RFP に記載されている、コストに見合った技術評価 60%、価格評
価 40%の配点で、RFP に基づき最も費用対効果の高い 1 社に供給契約が付与されます。

○概略日程

概略日程は以下の通りです：

マイルストーン	暫定日程
事前指示書 (PIN) の発行	2026 年 4 月 30 日
関心表明フォームの提出	2026 年 6 月 30 日
入札開始	2026 年 8 月 28 日
入札提出	2026 年 10 月 30 日
契約評価及び授与	2027 年 3 月

○必要経験

候補者は付属書 I に記載された経験と能力を持っている必要があります。

○契約期間と実行

ITER機構は2027年の3月ごろに供給契約を授与する予定です。契約期間は18か月の予定です。

○候補

参加は、個人またはグループ/コンソーシアムに参加するすべての法人に開放されます。法人とは、法的権利及び義務を有し、ITER加盟国内に設立された個人、企業又は機構をいいます。ITER加盟国は欧州連合(EURATOMメンバー)、日本、中華人民共和国、インド共和国、大韓民国、ロシア連邦、アメリカ合衆国です。

法人は、単独で、またはコンソーシアムパートナーとして、同じ契約の複数の申請または入札に参加することはできません。共同事業体は、恒久的な、法的に確立されたグループ又は特定の入札手続のために非公式に構成されたグループとすることができます。

コンソーシアムのすべての構成員(すなわち、リーダーと他のすべてのメンバー)は、ITER機構に対して連帯して責任を負います。

コンソーシアムとして許可されるために、その点で含まれる法人はコンソーシアムの各メンバーをまとめる権限をもつリーダーをもたなければなりません。このリーダーはコンソーシアムの各目メンバーのために責任を負わなければなりません。

指名されたコンソーシアムのリーダーは、入札段階で、コンソーシアムのメンバーの構成を説明する予定です。その後、候補者の構成は、いかなる変更もITER機構に通知することなく変更してはなりません。かかる認可の証拠は、すべてのコンソーシアムメンバーの法的に授権された署名者が署名した委任状の形式で、しかるべき時期にIOに提出しなければなりません。

どのコンソーシアムメンバーもIPROCに登録する必要があります。

【※ 詳しくは添付の英語版技術仕様書「Supply Contract for Lifting Hoist and Monorail for Handling of Baskets with Specimens of ITER Corrosion Monitoring Chambers」をご参照ください。】

ITER公式ウェブ <http://www.iter.org/org/team/adm/proc/overview> からアクセスが可能です。

「核融合エネルギー研究開発部門」のHP：<http://www.fusion.qst.go.jp/ITER/index.html>
ではITER機構からの各募集（IO職員募集、IO外部委託、IOエキスパート募集）を逐次更新しています。ぜひご確認ください。

ITER国際核融合エネルギー機構からの外部委託 に関心ある企業及び研究機関の募集について

<ITER 機構から参加極へのレター>

以下に、外部委託の概要と要求事項が示されています。参加極には、提案された業務に要求される能力を有し、入札すべきと考える企業及び研究機関の連絡先の情報を ITER 機構へ伝えることが求められています。このため、本研究・業務に関心を持たれる企業及び研究機関におかれましては、応募書類の提出要領にしたがって連絡先情報をご提出下さい。

PRIOR INFORMATION NOTICE (PIN)

IO/26/OT/10034607/ADC

Supply Contract for Lifting Hoist and Monorail for Handling of Baskets with Specimens of ITER Corrosion Monitoring Chambers

Prior Indicative Notice annexes:

- Annex I: Technical Specification ref. FRRNC3 v1.1 dated 17 March 2026
- Annex II: Expression of Interest

Abstract.

The purpose of this summary is to provide prior notification of the IO's intention to launch a competitive Open Tender process in the coming weeks. This summary provides some basic information about the ITER Organisation (the "IO"), the technical scope for this tender, and details of the tender process.

1 Introduction

This Prior Information Notice (PIN) is the first step of an Open Tender Procurement Process leading to the award and execution of a Supply Contract.

The purpose of this document is to provide a basic summary of the technical content in terms of the scope of work, and the tendering process.

The Domestic Agencies are invited to publish this information in advance of the forthcoming tender giving companies, institutions or other entities that are capable of providing these supplies the prior notice of the tender details.

2 Background

The ITER project is an international research and development project jointly funded by its seven Members being, the European Union (represented by EURATOM), Japan, the People's Republic of China, India, the Republic of Korea, the Russian Federation and the USA. ITER is being constructed in Europe at St. Paul–Lez-Durance in southern France, which is also the location of the headquarters (HQ) of the ITER Organization (IO).

For a complete description of the ITER Project, covering both organizational and technical aspects of the Project, visit www.iter.org.

3 Scope of the Package

Please refer to Annex I – Technical Specification ref. FRRNC3 v1.1 dated 17 March 2026

4 Procurement Objective & Process

The objective is to award a Supply Contract through a competitive bidding process.

The Procurement Procedure selected for this tender is the **Open Tender** procedure.

The Open Tender procedure is comprised of the following four main steps:

- Step 1 - Prior Information Notice (PIN) - publication on IO web procurement page

The Prior Information Notice is the first stage of the process. The IO formally invites interested candidate companies to indicate their interest in the competitive process by returning to the Procurement Officer the “Expression of Interest” using the template in Annex II via e-mail by the date indicated under the procurement timetable.

Special attention:

Interested candidate companies are kindly requested to promptly register in the IO Ariba e-procurement tool called “IPROC”, if not so done yet. The process on how to do is described at the following link: <https://www.iter.org/fr/proc/overview>.

When registering in Ariba (IPROC), suppliers are kindly requested to register at least one contact person. **The person identified in the Expression of Interest must be registered in IPROC.**

➤ Step 2 - Invitation to Tender

The Request For Proposal (RFP) package will be communicated with the interested candidates via email. The interested candidates will then prepare and submit their proposals in accordance with the tender instructions detailed in the RFP.

➤ Step 3 – Tender Evaluation Process

Tenderers proposals will be evaluated by an impartial evaluation committee of the IO. Tenderers must provide details demonstrating their technical compliance to perform the work in line with the technical scope and in accordance with the particular criteria listed in the RFP.

➤ Step 4 – Contract Award

The award will be done on the basis of best value for money or lowest price technically compliant offer as described in the published RFP.

5 Procurement Timetable

The tentative timetable is as follows:

Milestone	Date
Publication of the Prior Information Notice (PIN)	30-04-2026
Submission of expression of interest form	30-06-2026
Estimated Tender Launching	28-08-2026
Estimated Tender Submission	30-10-2026
Estimated Contract Award	March 2027

6 Experience Requirements

The candidates shall have the experiences and competences described in Annex I.

7 Quality Assurance Requirements

Prior to commencement of any work under this Contract, a “Quality Plan” shall be produced by the Contractor and submitted to the IO for approval, describing how they will implement the ITER Procurement Quality Requirements.

8 Contract Duration and Execution

The estimated award date and Contract signature is March 2027. The estimated contract duration is eighteen months.

9 Candidature

Participation is open to all legal entities participating either individually or in a grouping/consortium. A legal entity is an individual, company, or organization that has legal rights and obligations and is established within an ITER Member State.

Legal entities cannot participate individually or as a consortium partner in more than one application or tender of the same contract. A consortium may be a permanent, legally established grouping, or a grouping which has been constituted informally for a specific tender procedure. All members of a consortium (i.e. the leader and all other members) are jointly and severally liable to the ITER Organization.

In order for a consortium to be acceptable, the individual legal entities included therein shall have nominated a leader with authority to bind each member of the consortium, and this leader shall be authorised to incur liabilities and receive instructions for and on behalf of each member of the consortium.

It is expected that the designated consortium leader will explain the composition of the consortium members in a covering letter at the tendering stage (the Invitation to Tender). Following this, the Candidate's composition must not be modified without notifying the ITER Organization of any changes. Evidence of any such authorisation shall be submitted to the IO in due course in the form of a power of attorney signed by legally authorised signatories of all the consortium members.

10 Sub-contracting Rules

All sub-contractors who will be taken on by the Contractor shall be declared with the tender submission. Each sub-contractor will be required to complete and sign forms including technical and administrative information which shall be submitted to the IO by the tenderer as part of its tender.

The IO reserves the right to approve (or disapprove) any sub-contractor which was not notified in the tender and request a copy of the sub-contracting agreement between the tenderer and its subcontractor(s). Sub-contracting is allowed but is limited to 40% of the total Contract value. Rules on subcontracting in details will be indicated in the RFP itself.



IDM UID

FRRNC3

VERSION CREATED ON / VERSION / STATUS

17 Mar 2026 / 1.1 / Approved

EXTERNAL REFERENCE / VERSION

Technical Specifications (In-Cash Procurement)

Technical specification for supply of lifting hoist and monorail for handling of baskets with specimens of ITER Corrosion Monitoring Chambers.

The purpose of this technical specification is to describe the requirements for the design and procurement of a lifting hoist and monorail for handling of baskets with specimens of ITER Corrosion Monitoring Chambers.

SUPPLY

Table of Contents

1	PREAMBLE	2
2	PURPOSE	2
3	ACRONYMS & DEFINITIONS	2
3.1	Acronyms	2
4	APPLICABLE DOCUMENTS & CODES AND STANDARDS	2
4.1	Applicable Documents	2
4.2	Reference Documents	3
5	VV ISI CMC SYSTEM DESCRIPTION	3
5.1	VV In-Service Inspection Corrosion Monitoring Chambers overview	3
5.2	Supporting structure for the lifting hoist.....	7
5.3	Equipment, which needs to be lifted and handled	7
5.3.1	Upper Piping	7
5.3.2	Vessel lid.....	8
5.3.3	Removable basket assembly	8
6	LIFTING HOIST IN THE SCOPE OF SUPPLY	10
6.1	Main Lifting Tasks	10
6.2	Preconditions for Performing Lifting Tasks	10
6.3	Hardware in the Scope of Supply	10
6.4	Software in the Scope of Supply.....	10
6.5	Main Activities in the Scope of Supply	10
7	LIFTING AND HANDLING OPERATIONS	11
8	LOCATION FOR SCOPE OF WORK EXECUTION	13
9	IO DOCUMENTS & IO FREE ISSUE ITEMS	13
10	DELIVERABLES AND SCHEDULE MILESTONES	13
10.1.1	Tentative Schedule.....	13
11	QUALITY ASSURANCE REQUIREMENTS	14
12	SAFETY REQUIREMENTS	14
12.1	Seismic class	14
13	SPECIAL MANAGEMENT REQUIREMENTS	14
13.1	CAD design requirements.....	14
	APPENDIX I – LIST OF DOCUMENTS DELIVERABLES	15

SUPPLY

1 Preamble

This Technical Specification is to be read in combination with the General Management Specification for Service and Supply (GM3S) – [AD1] that constitutes a full part of the technical requirements.

In case of conflict, the content of the Technical Specification supersedes the content of [AD1].

2 Purpose

The purpose of this technical specification is to describe the requirements for the design and procurement of a lifting hoist and monorail for handling of baskets with specimens of ITER Corrosion Monitoring Chambers.

3 Acronyms & Definitions

3.1 Acronyms

The following acronyms are the main one relevant to this document.

Abbreviation	Description
GM3S	General Management Specification for Service and Supply
IO	ITER Organization
ISI	In-Service Inspection System
CMC	Corrosion Monitoring Chambers
PPE	Personal Protection Equipment
LTM	Long Term Maintenance
NPE	Nuclear Pressure Equipment
VV	Vacuum Vessel
SIC	Safety Important Class
PIC	Protection Important Class
SR	Safety Relevant
NSR	Non-Safety Related
ESP	Équipements Sous Pression (Pressure Equipment)
ESPN	Équipement Sous Pression Nucléaire (Nuclear Pressure Equipment)
FAT	Factory Acceptance Test

4 Applicable Documents & Codes and standards

4.1 Applicable Documents

This is the responsibility of the Supplier to identify and request for any documents that would not have been transmitted by IO, including the below list of reference documents.

Upon notification of any revision of the applicable document transmitted officially to the Supplier, the Supplier shall advise within 4 weeks of any impact on the execution of the contract. Without any response after this period, no impact will be considered.

SUPPLY

Ref	Title	IDM Doc ID	Version
[AD1]	General Management Specification for Service and Supply (GM3S)	82MXQK	1.4
[AD2]	ITER_D_SMP384 - Arrêté du 30 décembre 2015 modifié relatif aux équipements sous pression nucléaires - (TRANSLATION-EN)	SMP384	v2.5

4.2 Reference Documents

Ref	Title	IDM Doc ID	Version
1	FN7YXY_v2-TOC_WPL_P62_20505-TOC_WPL_P62_20505 - TO#08 - Manufacturing drawing (PN) - Manufacturing drawing - Type 1' and type 2 metallic corbels and beam - TOC_WPL_P62_20505-B1	FN7YXY	2.0
2	ITER_D_CC9CEV - TOC LDN P62_00007 - Calculation note for specific corbels and beam B11-L4-04 (TO#08)	CC9CEV	1.1
3	5X9GL5_v5-209369-0000-DE00-GAD-0012-209369-0000-DE00-GAD-0012 - CMC Vessel layout drawing-05	5X9GL5	5.0
4	04/25-20-4-0/1/2/3/4 - VV ISI CMC Basket lifting adaptor	DFGJNTH	01
5	LST-0001,RPT-0001 - Baseframe Manufacturing Drawing-02	7V4SKB	02
6	62MBV4_v6-W50-ITERFBUK-035331-EQ-EQD-W50-ITERFBUK-035331-EQ-EQD - VV ISI CMC Basket and Sub-baskets layout drawing-06	62MBV4	06
7	YWEJXE_v4-055832-055832 - VV ISI CMS GA---C	YWEJXE	04

5 VV ISI CMC System Description

5.1 VV In-Service Inspection Corrosion Monitoring Chambers overview

The primary purpose of the Vacuum Vessel In-Service Inspection Corrosion Monitoring Chambers is to monitor the evolution of corrosion in Vacuum Vessel material samples during the life of the ITER machine. The VV ISI CMC is in the Tokamak building, and is connected to the VV Primary Heat Transfer System (PHTS) downstream of the VV.

The VV ISI CMC will be used by the ITER Organization for performing periodic inspection and periodic requalification of the VV NPE, as required by the ESPN – [AD2]. ESPN and Équipements Sous Pression (ESP) stipulate the Operator (ITER Organization) is responsible for the maintenance, monitoring, and repairs required for the safe operation of the equipment.

SUPPLY

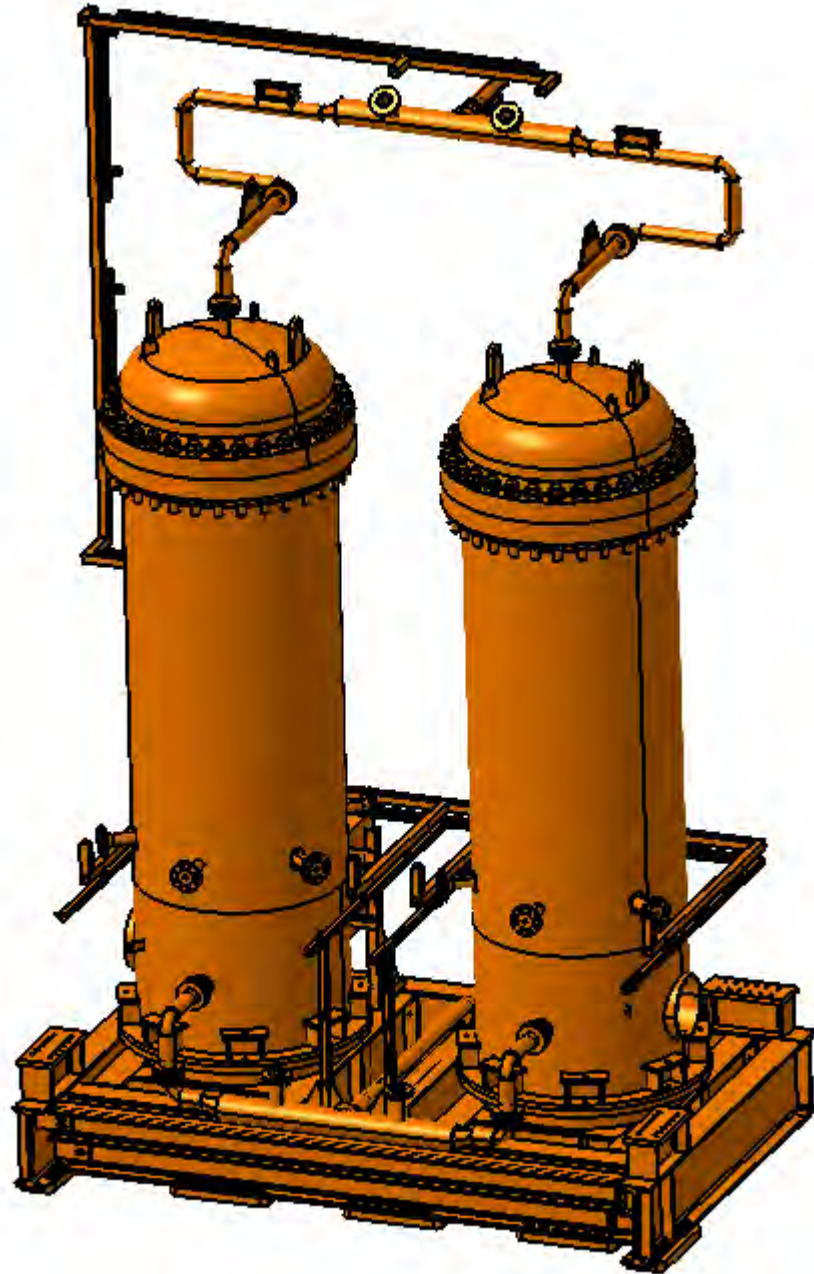

Figure 1 Corrosion Monitoring Chambers System

The VV ISI CMC shown in Figure 1 comprises:

- 2 Pressure Vessels
- Pipework for single point connection with the VV primary heat transfer system inlet & outlet, draining and venting
- Fixtures to hold the samples in baskets which can be removed to enable specimen inspection within the pressure vessels
- Flanges for interface, assembly, and maintenance
- Instrumentation for temperature and electrochemical potential monitoring within VV ISI CMC
- Silver/silver chloride reference electrode and platinum electrode in each CMC vessel, installed through 100mm flanged ports below the internal main basket containing the specimens
- Pressure gauges on each CMC

SUPPLY

- Data loggers to record operation data and associated shielded box to house them
- Thermal insulation to limit heat release to the room
- Structural supports for the pressure vessels and their pipework.

Drawings of these components can be found in the references [3] – [7] in the section 4.2 of this technical specification.

The component classification of the VV ISI CMC system is highlighted in the below Table 1, where the last two rows represent current scope of work.

Table 1: Components classification

VV ISI CMC Components	Safety class	Quality Class	Seismic class	ESP / ESPN category
Vessel	PIC/SIC-2	QC1	SC1(S)	IV/N3
Vessel lid	PIC/SIC-2	QC1	SC1(S)	IV/N3
Base Frame	NON-PIC / SR	QC1	SC1(S)	N/A
Pipework Upper	PIC/SIC-2	QC1	SC1(S)	IV/N3
Pipework Lower	PIC/SIC-2	QC1	SC1(S)	IV/N3
Electronic instrumentation equipment	NON-PIC / SR	QC1	SC1(S)	N/A
Basket	NON-PIC / SR	QC1	SC1(S)	N/A
Specimens	PIC/SIC-2	QC1	SC1(S)	N/A
Spool of pipe to connect to VV water cooling	PIC/SIC-2	QC1	SC1(S)	IV/N3
Human Access Platform	NON-PIC/ SR	QC1	SC1(S)	N/A
Corbel #1	NON-PIC/ NSR	QC1	SC1(S)	N/A
Corbel #2	NON-PIC/ NSR	QC1	SC1(S)	N/A
Cross-beam	NON-PIC/ NSR	QC1	SC1(S)	N/A
Monorail	NON-PIC/ NSR	QC1	SC1(S)	N/A
Lifting Hoist	NON-PIC/ NSR	QC1	SC1(S)	N/A

SUPPLY

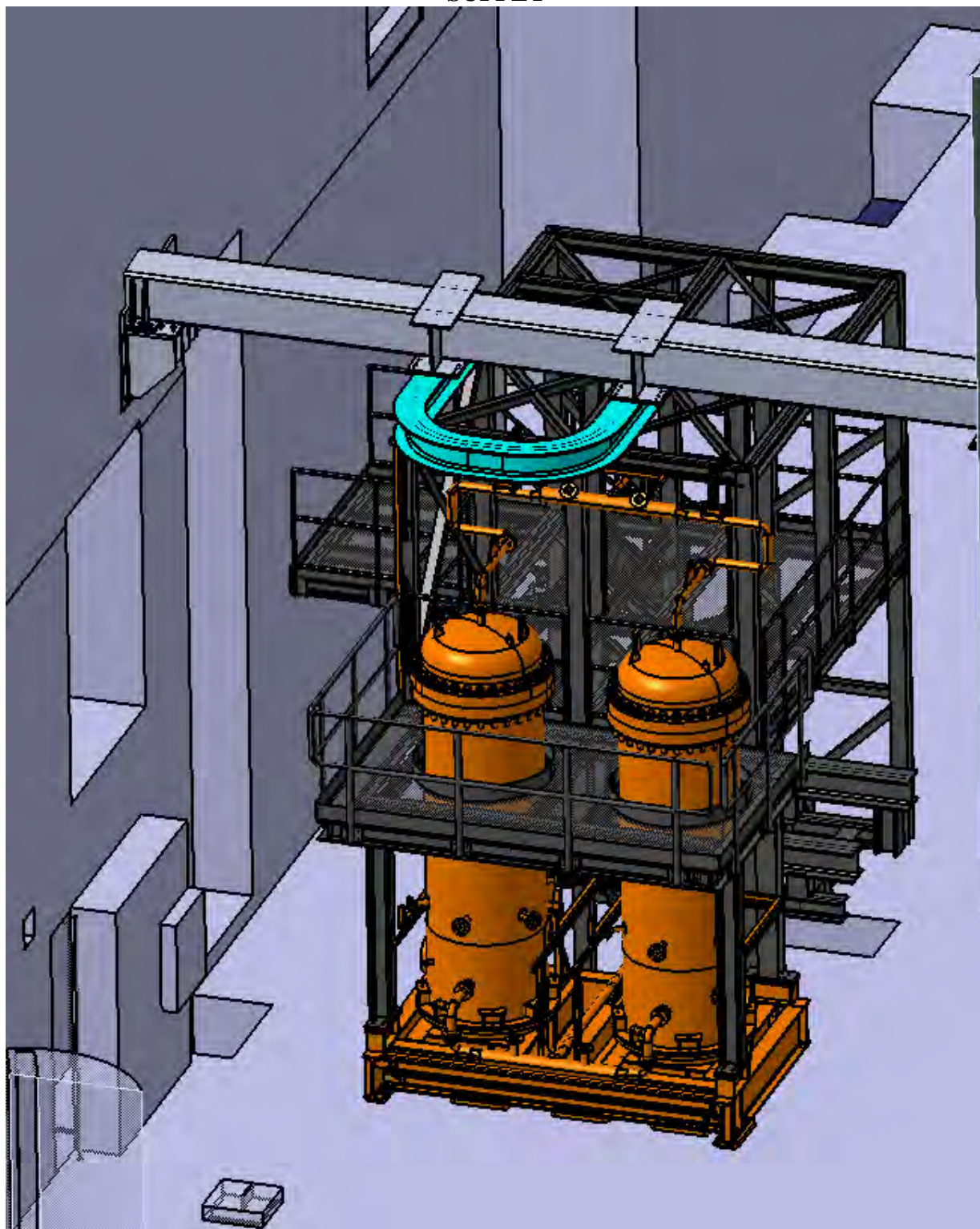

Figure 2. VV In-Service Inspection System Corrosion Monitoring Chambers is shown in the building with human access platforms and with supporting structure for the monorail.

The VV ISI CMC is a passive monitoring system, and as such it remains “in-service” throughout the plasma operation mode and the short-term maintenance mode. During the Long-Term Maintenance (LTM) mode the VV ISI CMC may perform these tasks:

SUPPLY

- Inspection of the specimens within the CMC (specimens/jigs will be removed c/w basket and sub-baskets to the Hot Workshop at L3 of Hot Cell Complex for inspection to be performed into an external Laboratory)
- Maintenance of the VV ISI CMC system itself.

5.2 Supporting structure for the lifting hoist

Corbel#1 and Corbel#2 as well as Cross-beam serve as supporting structure for the lifting hoist. Cross-beam has 2 welded pads with holes to bolt the counter plates of monorail.

Preinstalled supporting structure implies following requirements on the operability of monorail:

1. Monorail design tolerances referred to ISO 12488
2. Maximum lifting load (configuration "LTM"): 5 tons (assuming lifting hoist weight 0.3 tons, monorail weight to be considered), recommendations for the design of monorail are included in the calculation note [2];
3. Maximum beam displacement 5 mm, max. beam rotation 2.5 mrad for monorail operability with maximum lifting hoist load: 5 tons,
4. Recommended cross-section for the monorail: HEB300

5.3 Equipment, which needs to be lifted and handled

During long term maintenance the lifting hoist should lift and handle the upper lids of CMC vessels, should extract and handle the baskets with specimens along the U-shape monorail.

The two Corrosion Monitoring Chambers (Code of Construction ASME VIII, dv.2-2015) in stainless steel 316/316L provide an internal volume of approximately 3 m³ to house the main basket with sub-baskets / specimens / jigs, with a vessel wall thickness (shell and heads) of 20 mm.

The vessels have a domed end at top and bottom, with the top head being a removable head assembly to allow access to the main basket and sub-baskets/specimens/jigs within. The compression on the gasket (Spiral Wound with 316L windings and graphite filler, c/w 316L inner and outer rings) is ensured by 44 studs to provide a good sealing joint.

The chambers themselves are mounted on skirts that sit on the base frame ring through a bolted connection.

5.3.1 Upper Piping

Upper Piping at one point is connected to the Vacuum Vessel cooling water system and at 2 other points it's connected to Vessel #1 and Vessel 2. The Valve on the piping shall be closed before starting the maintenance and piping duct shall be drained and vented. The workers standing on the human access platform shall disconnect the piping. Upper piping consists of several pipes, connected with flanges (figure 3), all are from Stainless steel 316L. Total weight including lagging is around 30 kg. This equipment can be handled either manually or using lifting hoist. After disconnection and handling piping can be kept on the floor during maintenance and does not require transportation to the Hot Cell building.

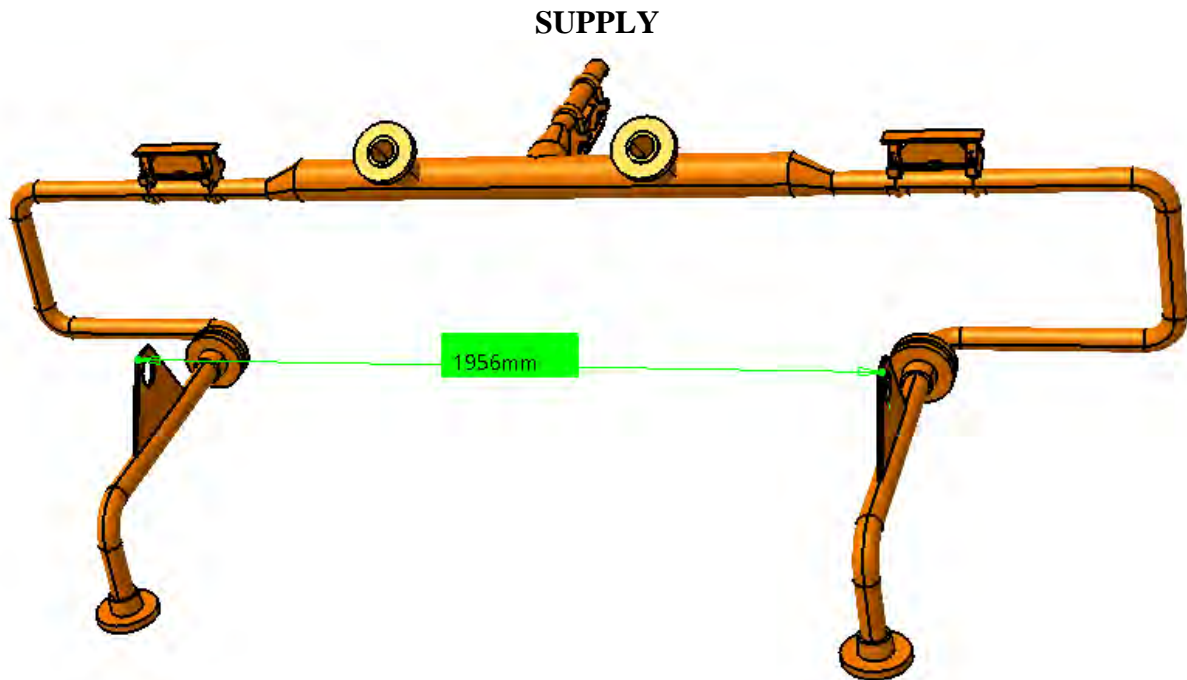

Figure 3 Upper piping

5.3.2 Vessel lid

Vessel lid is a top cover of CMC Vessel. Diameter is 1355 mm and overall weight including bolting is around 1 ton. Vessel lid is equipped with several lifting lugs which shall be used during lifting and handling.

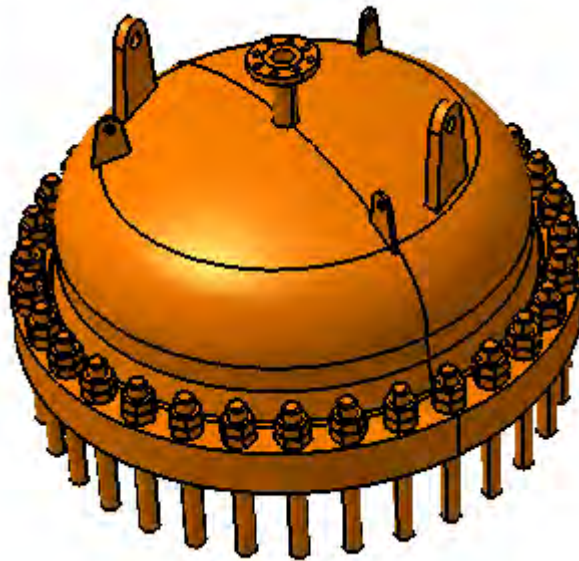

Figure 4 Vessel lid

5.3.3 Removable basket assembly

The main basket and sub-baskets maximize the available space within the Corrosion Monitoring Chamber to accommodate all the specimens and consider the limited headroom above the CMC vessel to allow for a lifting device and the main baskets removal from the system. The main basket, in stainless steel 316/316L is composed by an external structure with a top flange to be positioned on the CMC vessel ledge, three internal channels used to facilitate the installation of the 6-off sub-baskets (Figure 5 and 6). Each one of the 6-off sub-baskets (stacked on top of each

SUPPLY

other), in stainless steel 316/316L contains internally a “boxed” structure directly welded to the bottom flange of the sub-basket to house the different specimens with jigs and mesh walls mounted on the external perimeter of the component providing protection against loose items in the Corrosion Monitoring Chamber migrating into the VV PHTS.

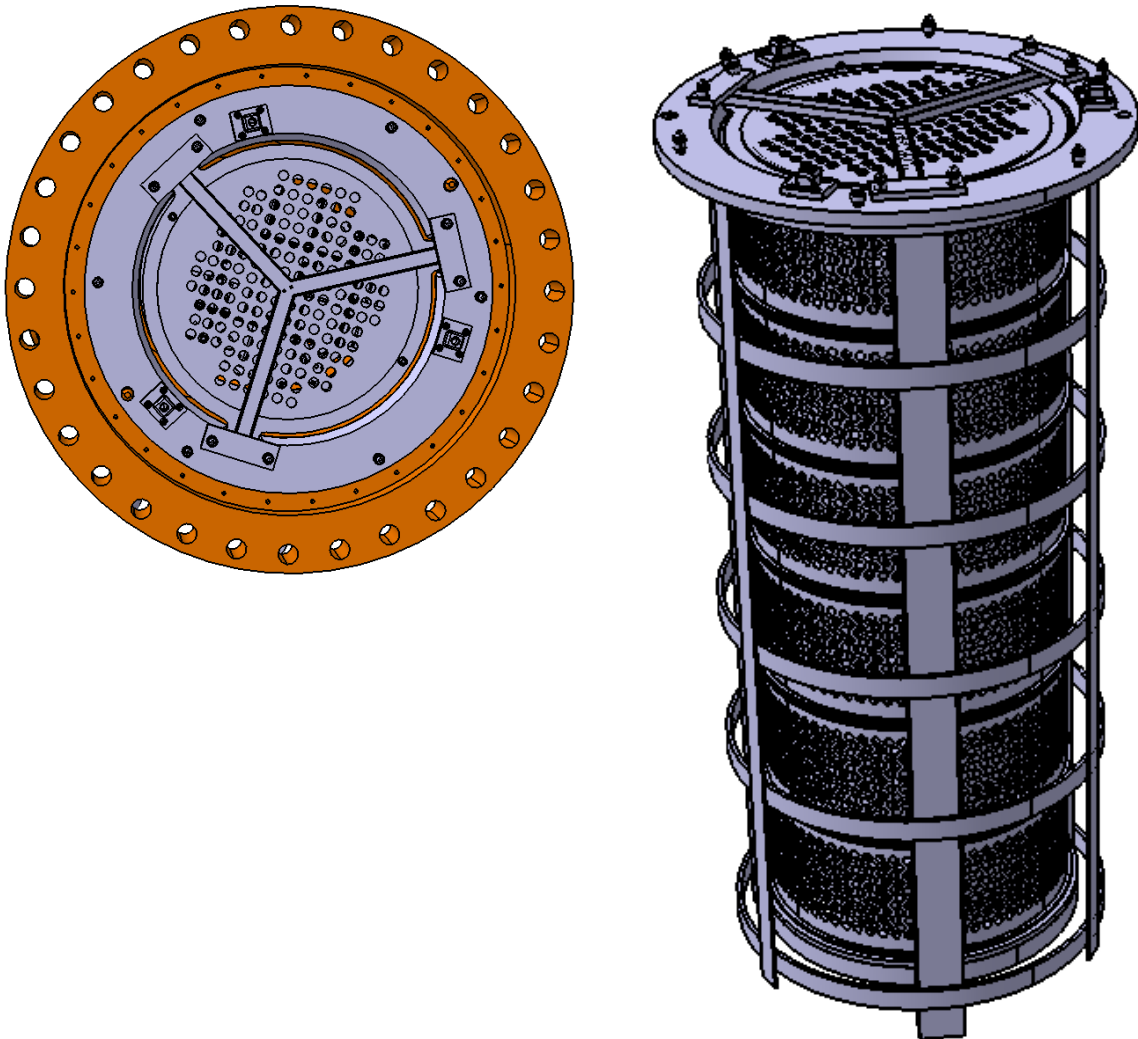

Figure 5 Main basket in the Vessel, top view Figure 6 Main basket extracted from vessel

Lifting hoist in the scope of this contract should be capable to extract and handle the main basket as a whole structure and lower it up to the floor level. The entire main basket will be placed in the transportation canister and shall be transported to the Hot Cell building.

Removable basket characteristics:

Main basket weight (empty): ~239 kg

Weight (full): ~1330 kg (including sub-baskets and specimens)

Main basket dimensions: h 2030 mm x Φ 980 mm

Service life: 20 years

SUPPLY

6 Lifting Hoist in the Scope of Supply

6.1 Main Lifting Tasks

The lifting hoist shall perform following tasks during each Long Term Maintenance and during initial assembly of WP7 In-Service Inspection System:

- Removal and installation of the upper piping spool;
- Removal and installation of the vessel lid;
- Removal and installation of the baskets with specimens.

For more details refer to Section 7.

6.2 Preconditions for Performing Lifting Tasks

Lifting hoist will be used when human access to this area is allowed and these operations are considered human assisted.

Before opening the vessels, the volume inside will be vented and drained to minimize the presence of corrosion products adhering to the corrosion specimens, jigs and basket assemblies.

6.3 Hardware in the Scope of Supply

Lifting hoist in the scope of this supply contract consists, but is not limited to, the following hardware:

- Curved U-shape monorail with its welded or bolted attachments to the preinstalled cross-beam;
- Lifting device (electrically handled hoist on the monorail);
- Control unit.

6.4 Software in the Scope of Supply

If applicable, the software shall be provided as required by the design of the lifting hoist.

6.5 Main Activities in the Scope of Supply

Main activities in the scope of supply of this contract include:

- Design and fabrication of the U-shape monorail considering the interfacing data and quality requirements provided by ITER.
- Investigation of the market and selection of suitable off-the shelf electrical chain hoist certified as per applicable EU Directives and European Norms (EN), e.g. Machinery Directive 2006/42/EC, Low Voltage Directive 2006/95/EC, EMC Directive 2004/108/EC.
- Demonstration that selected Manufacturer has proven experience in delivering of lifting equipment for nuclear facilities.
- Demonstration that safety-related functions are integrated in the hoist design thanks to rugged and proven electronic controls in comparison with conventional controls (e.g. performance Level C and Category 2 to EN ISO 13849-1 are satisfied as minimum requirements for the safety-related functions specified in DIN EN 14492-2).
- In addition, the following strengths of the selected chain hoist shall be targeted:
 - Individual customer solutions offered by the Manufacturer (to fit better to the ITER environment and needs).
 - Versatile and fully equipped as standard.
 - Proven technology.

SUPPLY

- Tough and reliable.
- High level of safety and reliability and long service life.
- Simple commissioning.
- Ergonomic operation.
- Minimum maintenance requirement and easy to service.

7 Lifting and Handling Operations

Lifting and handling operations will be implemented when human access in this area is allowed. For human access to the upper pipe spool the access platform with stairs is permanently installed. Human access platform can house up to 2 workers with minimum set of PPE (AS + TyvekL + simple mask).

Operations listed in the below table 2 will be implemented during each long term maintenance and foreseen 40 LTMs during 20 years of ITER operation.

During each long term maintenance, it is required to open 1 CMC Vessel and extract 1 main basket. Whereas during next LTM the opposite CMC Vessel shall be opened and corresponding main basket shall be extracted.

Main basket will be packed in the transportation canister and transported to Hot Cell building, where the specimens will be extracted, packed and to be sent to laboratory for analysis.

Whereas new specimens shall be installed in the main basket in the Hot Cell building and transported back to the Tokamak building. In the

Tokamak building the main basket shall be placed back in the dedicated CMC vessel using the lifting hoist.

The anticipation is for 10 working cycles during 1 working day.

Table 2: Lifting and handling tasks description

Task Description
To remove the top lid of the CMC Vessel, to handle it along the monorail, to lower it up to floor level, where it could be grabbed by workers and positioned on the floor.
To engage the lifting adaptor with the main basket lifting lugs, to lift the main basket containing sub-baskets with all the corrosion specimens from the CMC, to handle it along the monorail to position the basket in the canister.
Using lifting hoist, to lift the lid from the lay down area, to handle it along the monorail and to place it on top of CMC Vessel

Room layout is show in the figure 2. Lifting and handling space overall dimensions are in the below figures 7 and 8.

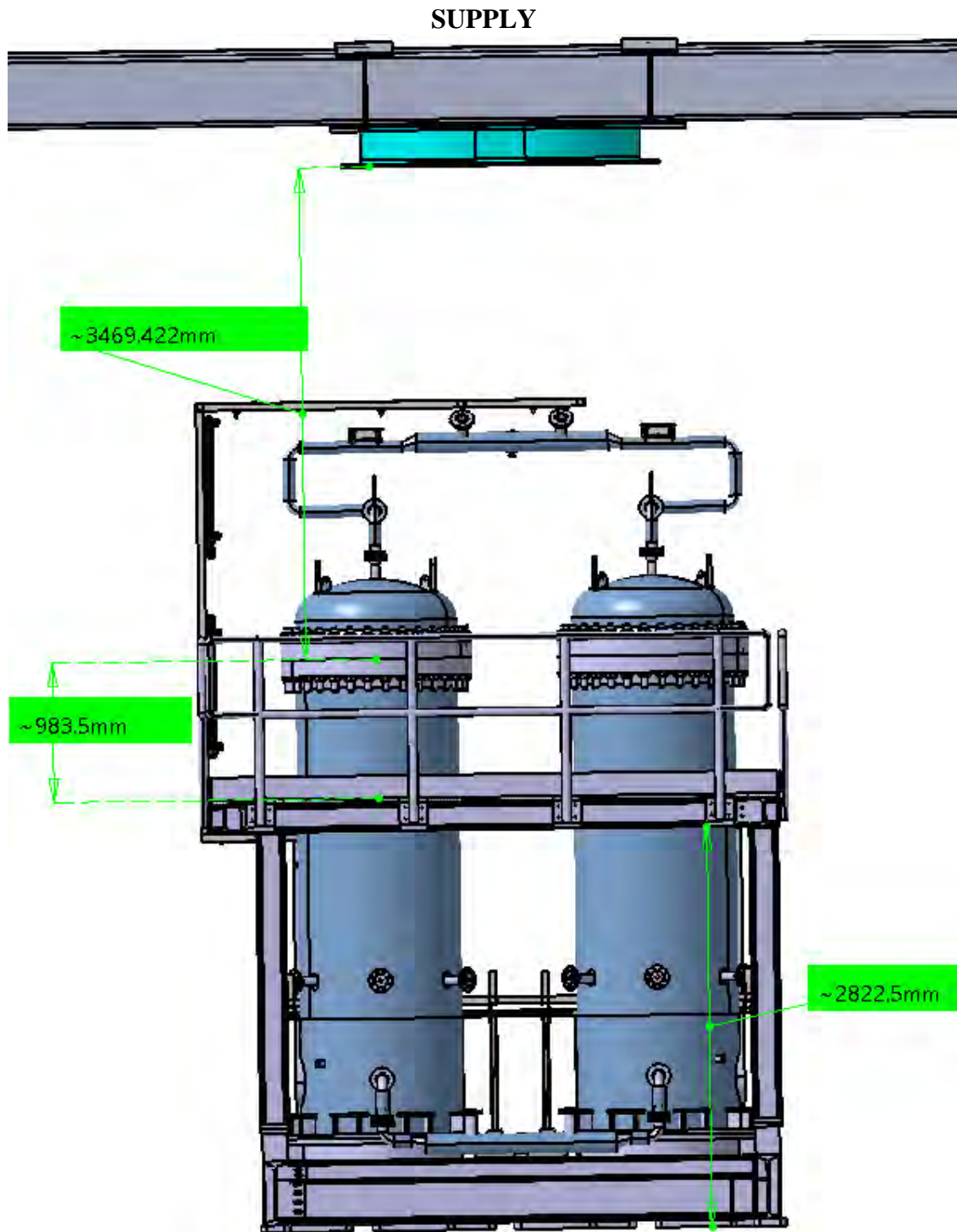

Figure 7 Lifting space layout, front view.

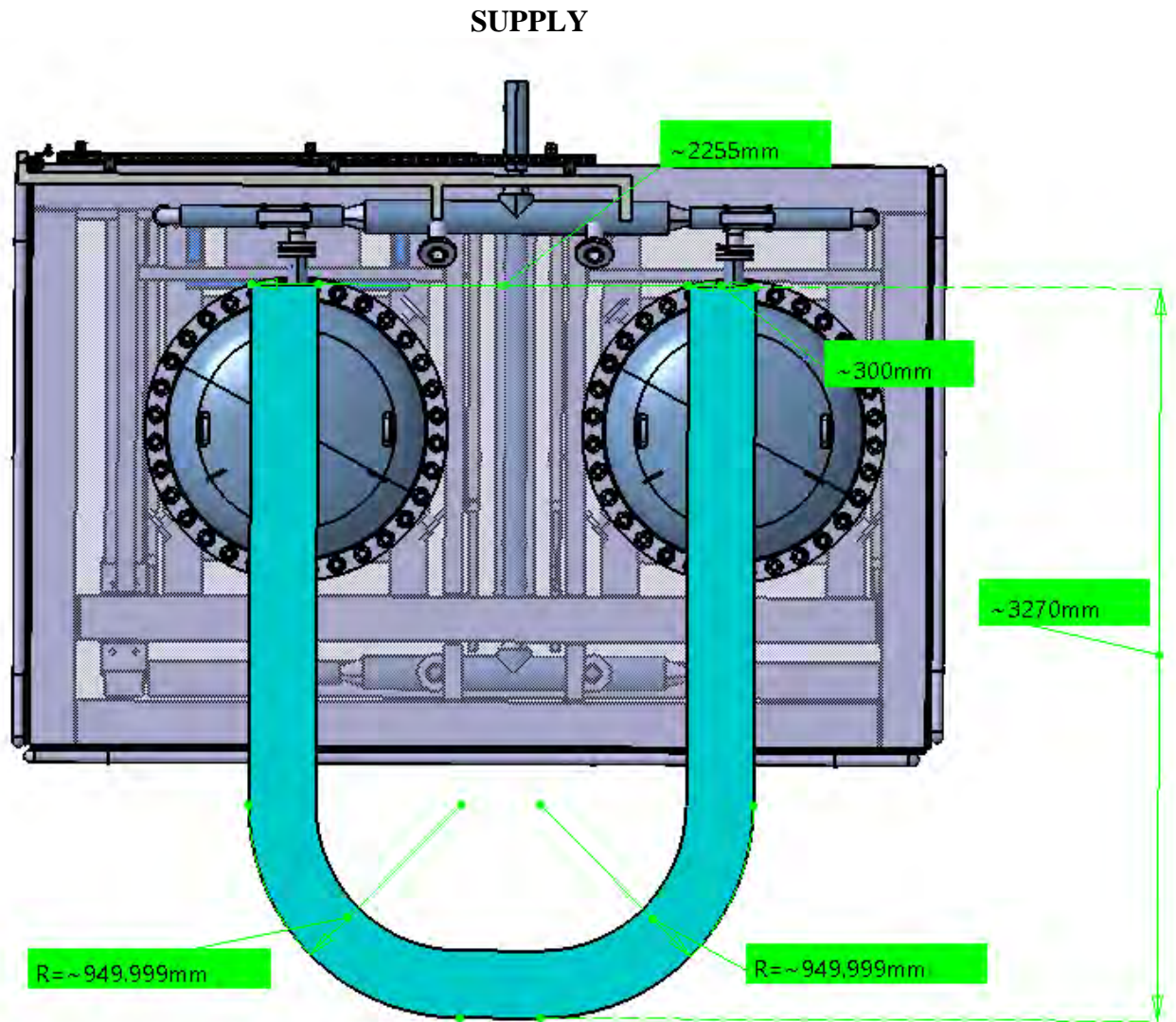

Figure 8 Handling space, top view, cross-beam not shown

8 Location for Scope of Work Execution

ALL the works in the scope of this contract are performed at supplier premises or supplier's subcontractors (off-site work).

9 IO Documents & IO Free issue items

As input data for the contract ITER will provide the 3D models and drawings of interfacing systems, including VV ISI CMC System, Corbels and cross-beam, human access platforms. ITER will also provide the calculation note for the corbels and cross-beam.

10 Deliverables and Schedule Milestones

10.1.1 Tentative Schedule

Schedule Milestones	Description	Is Contract Gate? (Y/N)	Expected Timing (T0+x) *

SUPPLY

#1	Manufacturing Design	Y	T0+6 months
#2	Manufacturing Readiness Review	Y	T0+8 months
#3	Factory Acceptance Test	Y	T0+15months
#4	Delivery	N	T0+18months

* TO = KOM date.

** Expected list of delivered documents is given in Appendix 1 (minimum but not limited to).

Delivery Conditions: The goods shall be delivered on the basis of Incoterms 2020 DAP (excluding customs duties and VAT) to the following address:

ITER Site located on the Route de Vinon-Sur-Verdon, CS 90046,
13067, Saint-Paul-lez-Durance,
France.

Installation of monorail and lifting hoist shall be done by assembly subcontractor and it is out of this contract scope.

11 Quality Assurance requirements

The Quality class under this contract is QC1, [AD1] GM3S section 8 applies in line with the defined Quality Class.

12 Safety requirements

The applicable standard for monorail and lifting hoist is EN 13001. Part EN 13001-2 of the standard states the applicable loads for design. Since the lifting and handling system in the scope of this contract has a planned interaction with PIC components, a specific additional safety factor shall be considered.

The most severe load combination considered is self-weight + seismic (Ex, Ey, Ez).

The calculation note [2] recommends following safety factors:

- The partial safety factor for fatigue loading: $\gamma Ff = 1$
- The partial safety factor for fatigue strength: $\gamma Mf = 1.35$

Monorail and lifting hoist are NON-PIC, QC1.

12.1 Seismic class

Components in the scope of this supply are seismic class: SC1(S).

13 Special Management requirements

Requirement for [AD1] GM3S section 6 applies in full.

13.1 CAD design requirements

This contract includes CAD works for the design of monorail and its interface to the cross-beam. This contract shall use the asynchronous CAD collaboration scheme, which include the following approach:

- ITER will provide the 3D Models of interfacing systems in the CATIA or in .stp format.
- Supplier must develop 3D models and manufacturing drawings of monorail in the scope of this contract and provide to ITER for approval before starting of manufacturing.

Appendix I – List of Documents Deliverables

This list outlines the key documents to be delivered. However, the deliverables are not limited to only listed hereunder: the rule to be considered is “as appropriate / as needed”:

1. Quality Plan.
2. 3D Models and Drawings.
3. Assembly Plan.
4. Operation Plan.
5. Maintenance Plan.
6. Manufacturing Inspection Plan (MIP).
7. Operation Manual.
8. Certificate of conformity.
9. End of Manufacturing Report (EMR);

ANNEX II

EXPRESSION OF INTEREST

To be returned by e-mail no later than 25 February 2026 to: Elizaveta.Kulaeva@iter.org copy Aurelie.Dubuc@iter.org

Tender Ref.: **IO/26/OT/10034607/ADC**
Description: **Supply Contract for Lifting Hoist and Monorail for Handling of Baskets with Specimens of ITER Corrosion Monitoring Chambers**
Procurement Officer: **Elizaveta Kulaeva**

Company Name:

Country of Origin:

- WE ACKNOWLEDGE HAVING READ THE PIN NOTICE FOR THE ABOVE-MENTIONED TENDER
- WE INTEND TO SUBMIT A TENDER
- WE ARE ALREADY REGISTERED IN IPROC
- WE INTEND TO REGISTER IN IPROC

Signature:

COMPANY STAMP

Name:

Position:

Tel:

Email:

Date: